

Micro-Lock Plus 1.25mm-Pitch Wire-to-Board Connector System

molex[®]

Ideal for compact applications, the Micro-Lock Plus Wire-to-Board Connector System provides electrical and mechanical reliability in a high-temperature design that meets automotive and other industry requirements

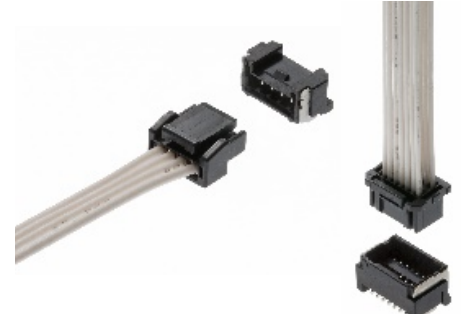

Micro-Lock 1.25mm-Pitch Wire-to-Board Connector System

Features and Benefits

Variety of connector colors

Aids assembly via color coding

Inner lock for dual-row versions; outer lock for single-row versions

Strengthens lock for more reliable connection

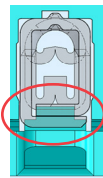
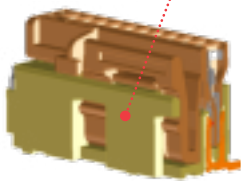

Expanded Terminal and Lance Contact Area

Smallest 1.25mm-pitch connector with positive lock

Delivers secure mating retention without sacrificing compactness

Wide positive latch that delivers audible click

Provides secure mating retention. Ensures proper mating

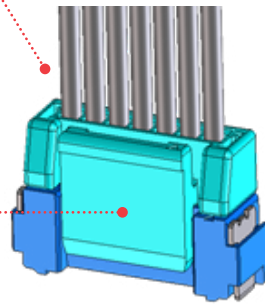

Dual contact terminal design

Offers secure contact and terminal retention

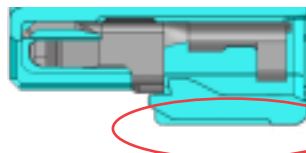

Increased Lance Thickness

2 to 42 circuits, single and dual rows, vertical and horizontal plug configurations

Offers design flexibility

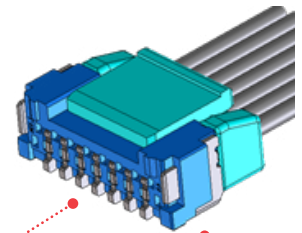

Tin-bismuth terminals Prevents whiskering for a clean and uninterrupted signal.

Supports terminal ruggedness and reliability

Robust metal solder tabs

Provides secure PCB retention and strain relief to solder joints

Withstands up to 105°C operating temperature

Meets automotive industry requirements. Withstands harsh environments

Applications

Automotive

- Steering wheel, paddle shift, combination switches
- Shifters
- Head-, rear-, side-mirror lights
- Internal connection with other units

Industrial Automation

Consumer

- White goods
- Gaming machines
- Drones
- Air conditioners
- Laser printers
- Vacuum cleaners



White Goods



Steering Wheel Switches



Gaming Machines



Drones

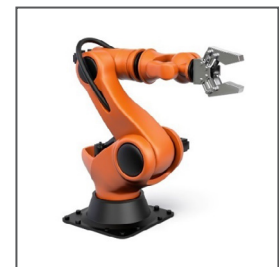

Industrial Automation

Micro-Lock Plus 1.25mm-Pitch Wire-to-Board Connector System



Specifications

REFERENCE INFORMATION

Packaging: Reel (Terminal); Embossed (Header Assembly); Bag (Receptacle Housing);
 Mates With: Micro-Lock Plus Connectors
 Use With:
 Terminal Used:
 Designed In: Millimeters
 RoHS: Yes

ELECTRICAL

Voltage (max.): 50V
 Current (max.): 1.5A
 Contact Resistance on Crimped Portion (max.): 5 milliohms
 Dielectric Withstanding Voltage: 500V AC
 Insulation Resistance (min.): 100 Megohms

MECHANICAL

Crimp Terminal Insertion Force (max.): 4.9N
 Crimp Terminal Retention to Housing (min.): 6.9N
 Mating Force: 9.8N (2 Circuit)
 Unmating Force: 0.3N (2 Circuit)
 Durability (min.): 30 Cycles

PHYSICAL

Housing:
 Receptacle — PBT
 Header — PA9T
 Contact: Copper Alloy
 Plating (Receptacle):
 Contact Area — Tin
 Underplating — Nickel
 Plating (Header):
 Contact Area — Tin Bismuth
 Nail Area — Tin over Nickel
 Operating Temperature: -40 to +105°C

Ordering Information

Series No.	Pitch (mm)	Component	Circuits	Rows	Color
505431	-	Female Receptacle Terminal	-	-	-
505565	1.25	Receptacle Housing	2 to 16	Single	Black
505567		Right-Angle Header			
505568		Vertical Header			
505432	1.25	Dual-Row Receptacle Housing	8 to 42	Dual	Black
505433		Dual-Row Straight Plug			
505448		Dual-Row Right-Angle Plug			

www.molex.com/link/microlockplus.html

Molex is a registered trademark of Molex, LLC in the United States of America and may be registered in other countries; all other trademarks listed herein belong to their respective owners.